

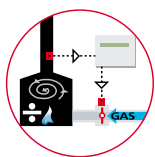

AVOID GAS AND CARBON DIOXIDE LEAKS WITH CHIMNEY FANS WITH INTEGRATED FAIL-SAFE

EXHAUSTO CDT's chimney fan systems for open gas fireplaces are the only ones on the market that feature an approved fail-safe functionality. This ensures that your family is not exposed to any unnecessary hazards from your open gas fireplace. You can both secure an existing gas fireplace or choose a new fail-safe model.

In addition, the chimney fan system gives you the freedom to choose your gas fireplace on the basis of what you want, rather than what the building architecture or layout will allow.



A safe system

The chimney fan control system makes sure to shut off the supply of gas if there is insufficient draught in the chimney to lead the potentially dangerous gases away from the room. It is the only system that is approved in accordance with the gas directive (EN298 GASTEC approval).



No risk of leaks

The chimney fan system creates optimal negative pressure in the chimney – irrespective of wind and weather conditions. As a result, you can be sure that there will be no leaks into the room.



Healthier indoor climate

Thanks to the optimal draught in the chimney, the chimney fan removes the hazardous flue gases. It also ensures a steady supply of fresh air.

EXHAUSTO CDT

CHIMNEY DRAFT TECHNOLOGY – SMART, SAFE AND EFFICIENT



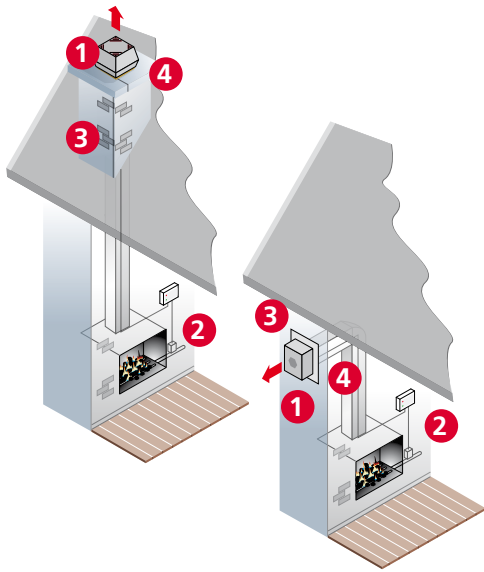

THE SYSTEM

The EXHAUSTO CDTs chimney fan system for gas fireplaces consists of

- 1 A chimney fan with integrated flow measuring system for safety monitoring (RSG, RHG, RSHG or RSVG)
- 2 A GASTEC approved control (EFC21 or EFC25)
- 3 An insulation switch
- 4 A flange, if the chimney fan is mounted on a steel chimney or a silencer for wall mounting.

The chimney fan is mounted on the top of the chimney or on the wall (RSG). Four types of chimney fans are available for gas: RHG, RSHG, RSVG and RSG. They are all fitted with a flow measurement system which – together with type EFC21 or EFC25 control systems – ensure that gas is not supplied to the fireplace unless there is sufficient draught in the chimney.

The RHG and RSHG are round chimney fans with horizontal discharge - i.e. the smoke is discharged to the side - and the RSVG is a rectangular chimney fan with vertical discharge - i.e. the smoke is discharged straight up into the air. RSG is a wallmounted chimney fan for gas. (please note: wallmounting not allowed in all countries)

The chimney fan can withstand continuous flue gas temperatures of up to 250 °C. It is made of die-cast aluminium with a grey paint finish which makes it light, mechanically strong and extremely resistant to corrosion. The RSG is made of stainless steel.

The fan motor is a temperature resistant, sealed asynchronous motor with lifetime lubricated ball bearings. This ensures a long service life, high efficiency and low noise levels.

There are two different controls - EFC21 and EFC25. Both have an EN298 GASTEC-approval. The EFC21 connected to a solenoid valve can be used for all open gas fireplaces whereas the EFC25 is used for open gasfireplaces with electronic ignition only.

It is legally required to fit an isolation switch in the immediate vicinity of the chimney fan so that, for example, chimney sweeps can disconnect the current to the chimney fan.

Read more about the fans, the controls and accessories at

www.exhausto-cdt.com



RHG



RSHG



RSVG



RSG



EFC21



EFC25



Servicebryter



lyddemper



Flens

3100078-0709

EXHAUSTO CDT A/S • Risingsvej 63 • DK-5000 Odense C
Tel: +45 70 10 22 34 • Fax: +45 70 10 22 35 • sales@exhausto-cdt.com

www.exhausto-cdt.com

EXHAUSTO CDT
SMART, SAFE AND EFFICIENT

